

## **BUD-PAK PTY LIMITED**

# **PRODUCT RANGE OVERVIEW**



### **Bud-Pak Pty Ltd**

2/29 Enterprise Drive  
Beresfield, NSW, 2322

Phone: (02) 4966 5357  
Fax: (02) 4966 8901  
Email: [email@bud-pak.com.au](mailto:email@bud-pak.com.au)  
Web: [www.bud-pak.com.au](http://www.bud-pak.com.au)

Australian Manufacturers of:  
Gross and Net Weighers,  
Packaging Systems, Process  
Lines, and more.

# CONTENTS

<b>1</b>	<b>BAGGING &amp; FILLING EQUIPMENT .....</b>	<b>3</b>
	BULKER BAG FILLING .....	3
	GROSS BAGGERS .....	3
	NET WEIGHERS .....	4
	RETAIL PACK WEIGHERS .....	4
	VALVE BAGGERS .....	4
	MULTI-HEAD WEIGHERS .....	5
	LIQUID FILLING MACHINES .....	5
	VERTICAL FORM, FILL & SEAL MACHINES .....	6
	BALING MACHINES .....	6
<b>2</b>	<b>BAG FORMING &amp; SEALING EQUIPMENT .....</b>	<b>7</b>
	BAG CLOSING CONVEYOR .....	7
	BAG TOP FORMER .....	7
	SEWING HEAD & PEDESTAL .....	7
	PORTABLE BAG CLOSER .....	7
	AUTOMATIC SEWING INFEED DEVICES .....	8
	BOX/CARTON FORMING MACHINES .....	8
	BOX/CARTON SEALING MACHINES .....	8
	BAG TURNERS .....	9
<b>3</b>	<b>PALLETISING &amp; DEPALLETISING EQUIPMENT .....</b>	<b>10</b>
	ROBOT PALLETISERS .....	10
	STRETCH WRAPPERS .....	10
	PALLET DISPENSERS .....	11
	PALLET CONVEYORS .....	11
	SLIP SHEET DISPENSERS .....	11
<b>4</b>	<b>ASSOCIATED EQUIPMENT .....</b>	<b>12</b>
	COMPLETE BAGGING LINES .....	12
	KIT PACKAGING .....	12
	PACKING DENESTERS .....	13
	AUTOMATIC VALVE BAG PLACERS .....	13
<b>5</b>	<b>CONTACT US .....</b>	<b>14</b>
	ABOUT BUDPAK .....	14
	AUTHORISED SALES & SERVICE AGENTS .....	14

# 1 BAGGING & FILLING EQUIPMENT

## BULKER BAG FILLING



Bulker-Bag Filling Systems for all materials are available from BudPak. BudPak manufactures a standard range of bulk bag fillers but can also custom design bulk bag fillers to suit clients' needs.

As well as manufacturing their own range of bulk bag fillers, BudPak also imports the highly regarded Technipes range (pronounced tek-nee-peez) of bulk bag fillers that are manufactured in Italy to tough European standards. Technipes has a history with bulk bag fillers in the flour industry in Europe and BudPak has numerous Technipes bulk bag fillers currently installed across Australia.

### FEATURES

- Fills up to 20 Bags per Hour
- Trade-Approved Design
- Solid Four-Loadcell Design
- Digital Display
- Up to 3,000kg Capacity, Other Capacities Available
- Choice of Digital Weight Indicators to Suit Your Application
- Self-Aligning Levelling Legs

### OPTIONS

- Automatic Control Panel to Control the Filling Cycle
- Integration to Other Equipment
- Filling Spout and Control Valve
- Overall Height
- Other Sizes Available to Suit All Ranges of Bags
- Chains and Hooks as Shown
- Fixed, Rigid Hooks

## GROSS BAGGERS

BudPak's proven range of Gross Baggers are suitable for bagging most types of products including dry, granular, lumpy, crushed or powdered products into bags up to 50kg. Gravity, Screw, Vibratory or Conveyor Fed, the GB Series Gross Baggers are based on digital weighing technology and pneumatic control. Over many installations, the design has proven to be both reliable and accurate.

The GB Series utilises the well proven "weigh in bag" method that has been perfected over many decades. The bag spout is fully suspended on precision loadcells and the dedicated weight controller ensures that accuracy is achieved.

### FEATURES

- Fully Electronic Loadcell Weighing System
- Fills up to 10 Bags per Minute
- Bag Weights up to 50kg
- In-flight Compensation
- RS-232/RS-422/RS-485
- Maximum 99 Preset Product Memories
- Totalised Bag Count and Weight for Each Memory
- Tolerance Check
- Two-Stage Filling
- Simple Operation and Maintenance

### OPTIONS

- Printers and Statistical Software
- Sewing Machines and Heat Sealers
- Bag Closing Conveyors
- Scissor Lift Table
- Turnkey Packaging
- Fully Stainless Steel Model Available



# NET WEIGHERS



Designed and manufactured in Australia to handle free and semi-free flowing products with limited operator interaction. The BudPak range of Net Weighers is available with a variety of in-feed options to handle almost any dry product.

The unit is totally electronic from the loadcells to the weigh indicator, which allows seamless interfacing with on-site computer management systems, if required. The range utilises a two-stage feed for maximum accuracy.

## FEATURES

- Bag Clamps
- Two-Stage Feed

## OPTIONS

- Dust Extraction
- Method of Infeed (Gravity, Auger or Conveyor)

# RETAIL PACK NET WEIGHERS

The PLA-G Series of Retail Pack Net Weighers is designed for high speed, high-accuracy weighing of free flowing and semi-free flowing products, from 100g to 3kg. Various models are available to provide throughputs from 10 to 100 weighings per minute.

High accuracy weighing is achieved using damped, single-point loadcells operating in conjunction with a PAK-SCAN/500 weighing controller, which provides self-tuning and auto-adjustment capabilities.

Years of reliability and trouble-free operation are evident through numerous existing installations throughout Australia and South East Asia.

## FEATURES

- Ideal for Packing 1kg, 2kg and 5kg Packs at a High Packing Rate
- Stainless Steel Components in Contact with the Product
- Designed and Manufactured in Australia



# VALVE BAGGERS



**V2550 FLUIDISING VALVE BAGGER**



**VA-25 AUGER VALVE BAGGER**

The BudPak range of Valve Baggers is a totally self-contained bagging system leading the way in bagging a range of products in to valve bags. The Valve Baggers are extremely unobtrusive to any site with a small footprint, simple installation (simply locate and connect to services), and silent running.

The Valve Baggers requires no special tools to complete installation and requires no tools at all to make operational adjustments. The system is controlled by a PLC.

## FEATURES

- Bag Weights From 5kg to 50kg
- Can be Skid Mounted
- Suitable for Bulk Densities Up To 2500kg/m<sup>3</sup>
- 50mm Bag Spout
- Two-Stage Filling with Pause Option
- 240VAC, 15A, 60Hz Single-Phase

## OPTIONS

- Dust Extraction Facilities
- Automatic Bag Ejection
- External Exhaust Facilities
- Stainless Steel Construction for Food-Grade Products
- Printers and Statistical Software
- Scissor Lift Table
- Turnkey Packaging

# MULTI-HEAD WEIGHERS



Multi-Head Weighers are ideal for packaging confectionery, bakery, biscuits, cereals, dried fruit, seeds, snacks, chips, flakes, nuts, pet foods, plastic parts, fasteners, fresh or frozen foods, etc. Multi-Head Weighers virtually weigh any dry products of varying shapes and sizes, including delicate products.

## INTEGRATION

Multi-Head Weighers are only one important piece of a production and packaging line. They must integrate seamlessly with a form, fill and seal machine to complete the packaging, and this is where BudPak also excels. BudPak can also supply a form, fill and seal machine or can integrate a BudPak Multi-Head Weigher with a client's existing FFS machine to ensure optimal throughputs and problem-free operation.

Many of BudPak's machines can also be connected to a computer network making integration to a software package and data collection very possible and cost effective.

## FEATURES

- Staggered dumping avoids blockages of the transfer tube
- Multiple languages in a single touch-screen display
- All surfaces in contact with the product are stainless steel
- All parts are enclosed to prevent product build-up
- Wash-down and dust-proof construction
- Touch-screen backlighting is adjustable
- Speed adjustment of hopper movement by stepper motor
- No air consumption
- 99 preset programs available

# LIQUID FILLING MACHINES

BudPak's Liquid Filling Machines are designed and manufactured in Australia for foaming and non-foaming products with limited operator input. A range of Liquid Fillers is available with a variety of options to handle almost any product.

Liquid Filling Machines are available in either a single-head or twin-head filling assembly or as an IBC (intermediate bulk container) filling assembly.

## FILL TYPES

- Top Fill - Generally used for non-foaming products
- Bottom Fill - Used where foaming products may cause problems.

## FILL METHODS

Two-stage filling with readily available adjustment, provides fast, accurate, and reliable weights. The system can accommodate three-stage filling if the product requires an initial slow fill.

## NOZZLES

Nozzles can be supplied for most size containers. Each is fitted with a wiper ring and drip cup preventing container contact with the product (if bottom fill is utilised).



IBC FILLER



SINGLE-HEAD FILLING LINE

## PUMPS

Stainless steel centrifugal pumps as used with appropriate seals.

## OPTIONS

- Pneumatic cap tighteners mounted on a swinging arm.
- Nozzle reversal upon misaligned containers.

# VERTICAL FORM, FILL & SEAL MACHINES

BudPak distributes the Esse Gi range of Vertical Form, Fill and Seal Machines. Esse Gi is a highly regarded International brand of VFFS Machines with a host of industry-leading features such as the automatic reel changing, greatly reducing the involvement of an operator in this task.

## ESSE GI F1200

What sets the model F1200 Vertical Form, Fill and Seal Machine apart from other machines is its ability to fill and seal large capacity bags up to 50kg. This is a distinct limitation with other machines.

The F1200 has in fact been designed to cater for the needs of even the most discerning customers while maintaining the simple construction and ease of use that has always distinguished this range of machine.

The F1200 Packaging Machine has been designed to work with several different types of films and with different batching and weighing systems. This sort of versatility makes it possible to work with many different kinds of products such as: short pasta, dried fruit, legumes, coffee, rice, frozen foods, bread yeast, salt, sugar, pepper, flour, detergent, chemical additives, cements, resins, animal feed, pet food, sand, various granules, fertilisers, earths, seeds, pellets and many others.

BudPak also distributes an entry-level range of Vertical Form, Fill and Seal Machines by AccuPak.

## FEATURES

- Touch Screen
- Film Reel Hydraulic Lifting
- Film Reel Self-Centring Locking
- Film Reel Automatic Centring
- End-of-Film-Reel Reading Sensors
- Automatic Print Centring
- Quick Film Reel Change Device
- Bag Bottom Vibrator Device
- Different-Size Program Storage
- Sealing Pincers Adjustable Opening
- Sealing Parameter Setting
- Automatic Bag Kicker
- Film Drive Speed Setting



## OPTIONS

- Blower Unit and Square Bottom
- Bag Piercing Devices
- Bag Shaking Devices
- Antistatic
- Markers and Coders of Various Types
- Equipped for Dust Extraction



## BALING MACHINES

BudPak distributes the Esse Gi range of Baling Machines. The machines are not so much a separate range of products, but rather an option for the F1200 and F1300 vertical form, fill and seal machines to allow them to bag compressible products such as hay, chaff, sawdust, and similar products.

BudPak has completed a number of installations in Australia of these machines with very satisfied (and very productive and efficient) customers. The image at right shows an Esse Gi F1300 vertical form fill and seal machine with the baling option fitted at the top.

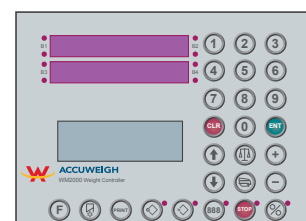
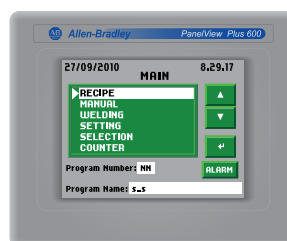

## ② BAG FORMING & SEALING EQUIPMENT

### BAG CLOSING CONVEYOR

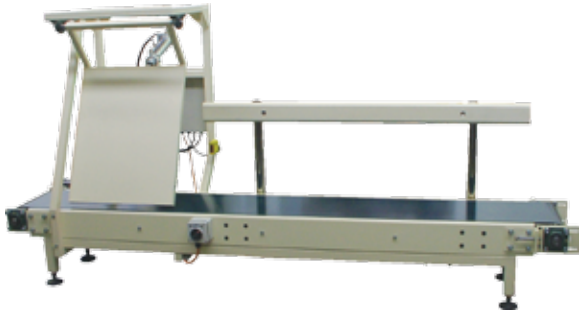

The closing conveyor is designed to prepare filled bags for sealing by shaping the bag and to accommodate all the requirements of a latter stages of the bagging system. A separate height and width adjustable back board is fitted to stabilise the bag during transportation.

Varying bag heights are handled by means of either a manual or power driven lifting mechanism to raise the whole conveyor. Full bag discharge can be either at right angles or in-line depending upon the required configuration.

### BAG TOP FORMER

The Bag Top Former has been designed to eliminate the simple operator task of hand feeding open filled bags to a sewing machine head or heat sealer. The filled bag is typically transferred along a Closing Conveyor to the sewing head and at this point, presentation to the sewing machine is critical to avoid missed or poor stitching and to avoid costly jam-ups.

In most packing lines, speed is critical so an operator is generally dedicated to simply hold and stretch the top of the bag and feed it into the sewing head. Apart from being a laborious job, it is costly to the employer and there is an element of injury risk.

The Top Former is pneumatically operated and only requires minor maintenance over a long period of time.



### SEWING HEAD & PEDESTAL



The sewing pedestal is manufactured to be mounted over any conveyor and can accommodate any bag height by means of manual or power driven height adjustment.

Control can be fully automatic stop, start and cut or manual depending upon the system operator requirement. A variable speed drive is standard to allow correct synchronization of speeds between the conveyor and sewing head.

The mounting head is universal and can accept most standard sewing heads. Normal fabrication is powder coated mild steel but stainless steel grade 316 is also available. A standard emergency stop / start station is mounted next to the sewing head. Power requirement is a normal 240 volt general purpose outlet.

### PORTABLE BAG CLOSER



For minimal cost closing of all kinds of bags. Single thread chain stitch, with simple mechanism for easier maintenance. New type NP-7A is provided with a plastic handle and an auto-lubrication feature.

MODEL	NP-7A
Capacity	1,700 to 1,900 RPM
Stitch Range	8.5mm (Fixed)
Seam	Single Thread Chain Stitch
Thread Cutting	Automatic
Drive Motor	240VAC, 90W
Net Weight	5kg with Thread
Gross Weight	Approximately 8.7kg
Volumetric Measurement	Approximately 0.75m <sup>3</sup>

# AUTOMATIC SEWING INFEEED DEVICES



The Automatic Sewing Infeed Devices, models CM4900-1, CM4900-3 and CP4900, can be mounted on a model A1-PB (DS-9C) pedestal type bag closing machine.

Infeed Speed: Standard 10m/minute Variable speed available on request. Induction Motor: 0.2kW, 3-Phase.

## MODEL CM4900-1

Automatic Infeed Device for plain sewn closure on paper bags and PP/PE woven cloth bags.

## MODEL CM4900-3

Automatic Infeed and Bag Top Trimming Device for crepe-tape bound closure on paper bags.

## MODEL CP4900

Automatic Infeed and Bag Top Folding Device for plain sewn closure on PP/PE woven bags. Top clearance required for folding: 170-200mm. Bag Top Folding Depth: 30-60mm

## OPTIONS

- Thread Break Detector
- Single Thread
- Needle Thread Oiler

# BOX/CARTON FORMING MACHINES

The BE MONOBLOCK is a high-speed, compact-size carton erecting machine, fitted with a powered magazine and bottom flaps sealer.

Folded boxes are picked from the magazine by a vacuum cups system which unfolds them and sets them ready for forming. The case is carried along the unit for a fast folding of the bottom flaps, and is set ready for filling and further top sealing.



## FEATURES

- Fully Automatic System for Erection and Bottom Flaps Folding
- Carton Width, Height and Length Adjustment
- In-built Air Filtering and Lubricating System
- Pressure Gauge with Flow Regulator
- Independent Speed Adjustment for Forming and Exit
- Siemens PLC Control
- Right- or Left-Hand Out-feed Alternatives
- Manually Adjustable Case Dimensions by Means of Cranked Handle, Fitted with Digits Display for Fast Operation
- Automatic Operation for Continuous Output of Cases or Manual Override for Single Delivery
- Height Adjustable Legs

# BOX/CARTON SEALING MACHINES



The D35NC machine has been specially designed for the upper and lower self-adhesive sealing of fixed-size cardboard boxes, with manual feed. What has been kept in mind in its design is the small and often overlooked details, achieving not only an easy to use machine but also one with a large output coupled with minimal maintenance. Its concept is simple and robust.

## FEATURES

- 50mm Taping Heads
- Automatic Upper Flaps Pneumatic Folder
- Box Height and Width Set by Cranks
- Upper Flaps Folding Rails
- Height Adjustable Legs
- In-built Air Filtering and Lubricating System
- Adjustable Air Pressure Gauge
- Upper Structure Supported by Four Masts
- Adjustable Flap Folding Timing, Both at Activation and Deactivation
- D35NC Standard: Transmission with One Motor. Reduction Through Pulleys
- D35NC Top: Transmission through Two Motor Reducers Directly to the Pulleys of the Arms

# AUTOMATIC SEWING INFEED DEVICES

---



The Bag Turner is designed to be used in conjunction with standard bag conveyors. Once a bag is sewn or heat sealed closed the bag is transferred along the conveyor to the bag turner. Once the bag is detected to be in the correct position, the bag clamp closes on the top of the bag, the bag is then turned through ninety degrees and then the bag is released.

The turning movement and the travel of the bag conveyor belt, turns the bag and lays the bag flat on the conveyor, in a butts-first orientation for further conditioning by an elevator flattener or similar. The conveyor is complete with all necessary controls and proximity switches for bag detection.

## FEATURES

- Fully automatic detection and bag processing
- Completely integrates with existing conveyors and other site systems

# 3 PALLETISING & DEPALLETISING EQUIPMENT

## ROBOT PALLETISERS



BudPak distributes the Fuji Ace range of Robot Palletisers. Every Fuji Ace robot comes with a touch screen control complete with:

- Preprogrammed pallet patterns embedded in the touch screen to meet your exact specifications
- 60 programmable memory recipes. Once utilised, recipes can be switched within seconds
- Onboard automatic lubrication schedule
- Onboard diagnostics designed to identify errors instantaneously
- Onboard error log history Inventory monitoring that corresponds with specific recipes
- High level programming software offering complete onboard control and recipe editing without the need of a laptop computer
- Real time I/O monitoring
- Comes with a user friendly teaching pendant

### MECHANICAL ADVANTAGE

- Unique linear track design contributes to decreased power consumption by 50% or more while achieving up to 600 cycles per hour
- The articulated arm movement is driven by the combination of a servo motor, timing belt, recirculating linear guide bearings and two hardened steel ball screws
- Uses a 5 to 1 movement ratio on the Z axis (arm movement up or down)
- Uses a 6 to 1 movement ratio on the R axis (arm movement in or out)
- The robot pivots (Theta axis) up to 330° on a high density cross roller thrust bearing designed for years of trouble free operation in harsh environments
- The arm end is designed to pivot up to 330°

### FEATURES

- Ultra quiet operation
- Unique linear guides designed specifically for palletising (Exclusive to Fuji Ace)
- Polycarbonate cover to reduce weight EC Series (Energy Conservation) designed to save energy, resources, and money
- Simple, compact and durable design
- Multiple end effector applications for bags, boxes, cases, pails, drums, bottles, and shrink wrapped packages

### OPTIONS

- Cold environment upgrade
- Harsh environment upgrade (stainless steel components)
- Memory program expansion
- Auto reject function
- Simultaneous multi-size product handling (5th axis)
- Slipsheet placement
- Pallet placement

## STRETCH WRAPPERS

BudPak distributes the DNC range of Stretch Wrappers. The range starts with semi-automatic entry level units and ends at fully automatic, high-speed units.

### FEATURES

- Suitable for all types of film
- Automatic film hooking, wrapping, sealing and cutting
- Polycarbonate cover to reduce weight EC Series (Energy Conservation) designed to save energy, resources, and money
- Simple, compact and durable design
- Multiple end effector applications for bags, boxes, cases, pails, drums, bottles, and shrink wrapped packages

### OPTIONS

- Light Curtains and Interlock Fencing for Maximum Operator Safety
- Pallet Dispensers
- Powered In-feed and Out-Feed Roller Conveyors



## PALLET DISPENSERS



The Pallet Dispenser is designed to automatically dispense pallets from a magazine stack to the robot palletiser loading station resulting in a continuous supply of pallets to the robot palletiser.

The Pallet Magazine allows the operator to load the Pallet Dispenser with up to 12 empty pallets. The Pallet Magazine consists of a heavy-duty construction, three-sided magazine complete with pallet guide to ensure the pallet stacks are loaded squarely and centrally to the take-away conveyor. The three-sided magazine also provides a level of safety to both operators and equipment, preventing the pallet stack from toppling over should the pallets not be stacked squarely.

The advantages of this type of Pallet Dispenser are that the floor space required for installation is minimal, and both the capital expenditure and overall running costs are lower with this style of Pallet Dispenser.

### FEATURES

- Holds up to 12 empty pallets
- Low site footprint
- Low running costs

### OPTIONS

- Pallet Conveyors
- Site Integration

## SLIP SHEET DISPENSERS

The Slip Sheet Dispenser is designed to automatically place lightweight pre-cut corrugated fibreboard sheets onto pallets prior to loading. The slip sheet applicator comprises a slip sheet magazine, horizontal carriage and vacuum head assembly, and vacuum switch to detect the presence of a vacuum on the suction cups.

The unit is typically supplied as fully automatic and fully integratable.



## ④ ASSOCIATED EQUIPMENT

### COMPLETE BAGGING LINES & TURNKEY SYSTEMS



#### FEATURES

- Engineered solutions for your products
- Engineered solutions for your throughput and required accuracy
- Massive range of equipment from start of production line to end of production line

BudPak's strength lies in its design capabilities. We are more than a standard component manufacture or supplier. We are at our best engineering a packaging solution for your product, to your speed and accuracy requirements, and to fit in your available factory space. We have electrical, electronic and software expertise in-house. We can design control systems to suit your requirements and interfaces.

As you can see from our equipment list, BudPak can manufacture complete packaging lines. The extreme of this capability is the turnkey project. You place one order - BudPak will design a complete system, be responsible for all necessary interfaces, manufacture, supply, installation, commissioning and training, and remain your single point of contact and responsibility for on-going support - and we do this with a single up-front price.

No open-ended and ongoing consultant fees, no split responsibilities, no interface arguments, no delivery scheduling problems - just your specifications and BudPak's firm price and delivery.

### KIT PACKAGING

From simple single item kits, such as fixed quantity fastener boxes, to multiple item kits sealed in plastic welded pockets, BudPak has a kit packaging solution for your application.

The solution can be as simple as a single, digital counting scale to a complex kit packaging line complete with carton forming, carton closing and palletising.



#### FEATURES

- Systems available to suit any site throughput
- System configurations available to suit required site footprints
- Systems are expandable for future growth or budget



# PACKING DENESTERS



BudPak distributes the AccuPak range of packing denesters. These units automate the separation of the product packing containers from their stack and prepare them for product insertion. These machines often achieve higher denesting rates and greater placement accuracy than human operators. The task of denesting packing containers is also very repetitive and ideally suited to a machine.

The basic models can achieve 60+ placements per minute with a single lane operating while other models handle multiple lanes allowing much higher placement rates. Rotary style units also have higher placement rates.

The task of exchanging pick and place fittings to suit different packing containers, one of the more laborious tasks of denester machines, is made simple with the AccuPak range of denesters with their "Plug and Go" system.

## FEATURES

- Throughputs from 60 to 360+ Placements
- Complete Integration with Other Process Line Equipment

## OPTIONS

- Tray Insert Placement Available
- Lid Placement and Compression Available
- Single-Lane or Multiple-Lane

## TRAY INSERTION

Denester machines can also be used to place inserts in to packing containers such as aluminium trays. This is ideal for the ready-meal industry and similar food products.

## LID PLACEMENT & COMPRESSION

Some denester units integrate a lid placement unit (very similar to the basic pick and place denester) with a lid compression unit, completing two tasks in quick succession.

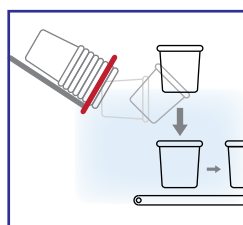

Pick and Place Denesters

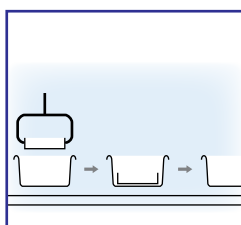

Tray Insertion Systems

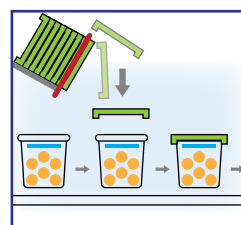

Lid Placement Systems

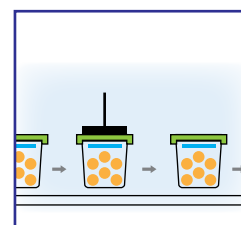

Lid Compression Systems

# AUTOMATIC VALVE BAG PLACERS

The AccuPak model Transfer/R automatic valve bag placer is suitable for paper, polypropylene and polyethylene valve bags of different sizes ranging from a minimum of 5kg to a maximum of 50kg. The valve size can range from a minimum of 90mm to a maximum of 180mm.

Simple, reliable, compact, and with absolutely minimal maintenance makes this automatic valve bag placer one of the most widely used bag placers on the market. It can be installed in any working environment, even in the presence of abrasive products and/or chemical agents. It can furthermore be combined to already-existing bagging machines (where available room is sufficient).

It is supplied complete with an empty bags magazine, both fixed and automatic, having a capacity of 40 to 50 bags at every station.

## FEATURES

- Frees operators from the mundane task of manually placing valve bags on to the bagging machine's valve spout
- Massive throughput rate to match any bagging rate



# 5 CONTACT US

## ABOUT BUDPAK

### QUICK FACTS

- Formed in 1974. We are 35+ years old.
- Based in Newcastle, NSW.
- Owned by the largest Weighing, Filling, Packaging and Inspection Equipment company in Australia - Accuweigh Pty Ltd!
- Provide a comprehensive range of equipment from start to finish.
- Has numerous equipment installations around Australia and South East Asia.

Remember that if you need to bag it or box it

... best to BudPak it!

BudPak Pty Ltd was formed in 1974 in Newcastle, NSW. The establishing partners had already amassed many years experience in the packaging industry when they created BudPak Pty Ltd.

The company started operations manufacturing gross and net bagging scales but soon showed a steady growth in design capability and equipment offered. 1984 represented a significant year with BudPak Pty Ltd developing a major micro-processor based control system for its weighers (which led the world in the application of this technology to the packaging field). BudPak Pty Ltd also committed itself to Computer Aided Design.

This pattern of applying new technology to its designs and operations has continued to the present day, to the point where complete turn-key manufacturing systems are now offered.

In 2004, BudPak Pty Ltd was acquired by Accuweigh Pty Ltd, a national Weighing, Filling, Packaging and Inspection Equipment company with the intention of Accuweigh Pty Ltd to strengthen its Packaging Equipment range and to further enhance the BudPak name throughout Australia.

BudPak Pty Ltd continues to trade under its own name and the acquisition has provided major benefits to both companies. BudPak Pty Ltd is now able to utilise the national servicing capabilities of Accuweigh Pty Ltd. BudPak Pty Ltd was always able to provide servicing to its equipment anywhere in the world, but now has access to a larger range of fully trained and approved service technicians throughout Australia providing fast and efficient service work for our clients.

BudPak Pty Ltd has shown that it is not afraid of the difficult projects or difficult products. The company often works with their clients to solve the problems associated with packaging difficult products. This wealth of experience is available for your benefit in solving your packaging problems.

From the simplest packaging line to the most complex, from the simplest products to the most difficult, BudPak Pty Ltd's years of experience, equipment range and expertise is a powerful set of tools in meeting your requirements.

## AUTHORISED SALES & SERVICE AGENTS

It's important to use a BudPak-authorized service agent to ensure genuine replacement parts are used and experienced and trained service personnel perform the equipment servicing and repairs.

### ADVANTAGES

- Fully trained on BudPak equipment and machinery.
- Experienced working on BudPak equipment.
- Carry genuine replacement parts and components.
- Have access to genuine BudPak Service Documentation.
- Have access to BudPak Head Office for training and support.



NEWCASTLE:  
29 Enterprise Drive, Beresfield, NSW, 2322  
Phone: (02) 4966 5357



ACCUWEIGH

NEW SOUTH WALES:  
3 Kurrara Street, Lansvale, NSW, 2166  
Phone: (02) 9728 4877

WESTERN AUSTRALIA:  
19 Yampi Way, Willetton, WA, 6155  
Phone: (08) 9259 5535

VICTORIA:  
20 Yiannis Court, Springvale North, Vic, 3171  
Phone: (03) 9548 5512

QUEENSLAND:  
Unit 3, 27 Kingtel Place, Geebung, Qld, 4034  
Phone: (07) 3265 5520

SOUTH AUSTRALIA:  
5 Endeavour Drive, Port Adelaide, SA, 5015  
Phone: (08) 8447 5011



QUEENSLAND:  
Unit 3, 27 Kingtel Place, Geebung, Qld, 4034  
Phone: (07) 3265 5520